



**8th Grade
Parent Night
2.6.24**



welcome

CLASS OF 2028!

Once a
Highlander,
always a
Highlander



THE PODIUM



ADMINISTRATIVE TEAM:

- **Krisha Charbonneau**
Assistant Principal, 9th Grade
- **Chuck Demarest**
Assistant Principal, 10th Grade
- **Patrick Malone**
Assistant Principal, 11th Grade
- **Ryland Huff**
Assistant Principal, 12th Grade

- **Kaysha Reinhart**
Principal Assistant
- **Brett Noble**
Principal Assistant
- **Beau Tilleman**
Athletic Director



Class of 2028 Counseling Staff

- **Stephanie Filippini**
9th Grade Counselor
- **Alana Depaolo**
9th Grade Transition Counselor



Academic Support Staff

- **Steve Yelenich**
Interventionist

- **Darnell Handcox**
Interventionist

- **Bailey Anderson**
Interventionist



Mission:



- At Shadle Park HS, EVERY student will be known by name, story, strengths, and needs.
- At Shadle Park HS, ALL students graduate on-time, equipped with the skillset, mindset, and habits to be opportunity ready in a 21st century world.



To live out our mission we will:

- Create an environment where students and staff are equally challenged, supported, and loved.
- Create an experience for students and staff that expands the level of hope they have for themselves and their future, as well as increasing their sense of belonging within our school community.
- Support students in planning and preparing for their future in a way that aligns to their passions, hopes, and dreams.

WHAT IT MEANS TO BE A HIGHLANDER

- Highlanders take **pride** in themselves, their actions, their school, and their community; understanding they are part of something bigger than themselves.
- Highlanders **care** for, **love** and **support** their school, their community, and other Highlanders.
- Highlanders **set goals** and **challenge themselves**, knowing it takes planning and preparation to reach their fullest potential and be ready for whatever their future may hold.
- Highlanders **get involved**, **have fun**, and **make memories** that last a lifetime.



PARTNERSHIP





**ATTENDANCE
MATTERS**

Attendance is ***CRITICAL*** to student success in school – both ***academically*** and ***socially!*** We want, and need, you here!



COMMUNICATION

- Communication supports our partnership!
- **Communication Avenues:**
 - Weekly Proud to be SP Newsletter!
 - Email from teachers/counselors/support staff
 - Phone calls from teachers/counselors/support staff
 - Visiting our school website
- Teachers and support staff will communicate if a student is struggling, should an issue arise, or if the student is in danger of not earning credit for a class.



COMMUNICATION

I opted out of calls or texts. How do I opt back in?

- You can opt back in to voice calls by **calling 855.502.7867.**
- You can opt back in to text messages by **texting START to 60680.**

RESOURCES & SUPPORTS



Students

Learn

Activities

Community

About



Shadle Park High School ▶ About ▶ Resources and Supports ▶ Resources and Supports

Resources & Supports

Accessible via our
website under the
'About' tab

Resources and Supports

Counselors:

Alana Depaolo (9th Grade Counselor)

Christy Peterson (9th Grade Counselor)

Lesla Renner (10th Grade Counselor)

Tippy Terrell (11th Grade Counselor)

Stephanie Filippini (12th Grade Counselor)

- Provide mental health crisis support for students
- Provide short term individual and small group counseling services for students
- Advise and support academic and future planning
- Connect students and families with community resources
- Collaborate with classroom teachers to provide SEL support
- Coordinate and support student transitions between schools and grade levels
- Facilitate and/or collaborate around MTSS teams





GETTING INVOLVED!

*We want you to be involved!
Student involvement in
athletics, arts, clubs, and
activities promotes
connection to school and
academic and social success!*



HIGH

24 TOTAL CREDITS

17 FOUNDATIONAL

7 ELECTIVES

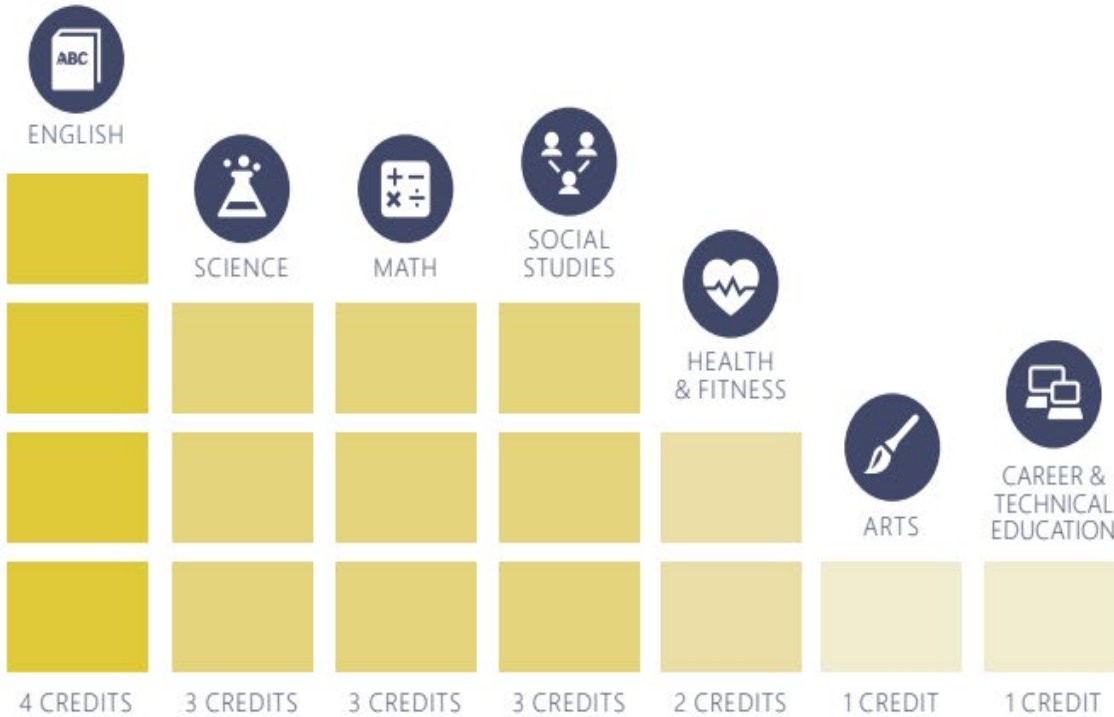

HIGH SCHOOL GRADUATION REQUIREMENTS

* Personalized Pathway Requirements (PPR) are electives in any subject that align with the student's interests and their High School and Beyond Plan. The arts and world language credits can be replaced with other electives, based on the student's plan.

Credit Requirements	High School Graduation Requirements <i>***Class of 2021 and Beyond***</i>	State of Washington College Admission Requirements <i>(4-year university based on CADRs)</i>	NCAA Athletic Eligibility <i>(Division I and Division II)</i>
Subject Area	Credits	Credits	Credits
English	4	4	4
Math	3 <i>(Algebra I, Geometry, and Year 3 math)</i>	4 <i>(Algebra I, Geometry, and Algebra 2+)</i> <i>***4-year universities expect students to successfully complete Pre-Calculus or take a math course during the senior year***</i>	3 <i>(Algebra I, Geometry, and Year 3 math)</i>
Science	3 <i>(2 must be lab sciences)</i>	2 <i>(both must be lab sciences and one must be an algebra-based science)</i>	2 <i>(1 must be a lab science)</i>
Social Studies	3	3	2
World Languages <i>(***or Pathway Aligned Elective)</i>	2 <i>(Students who have post-secondary goals other than attending college may select 2 Pathway Aligned Elective credits as opposed to World Language credits.)</i>	2+ <i>(must be consecutive years of the same language)</i>	<u>Additional Core Courses:</u> 5 <i>Including 1 additional English, Math, or Science course. The other 4 courses can include any of the above content areas, World Language, or Philosophy.</i> ***In order to be academically eligible to play Division I athletics, student-athletes must hold a minimum of a 2.3 GPA in their core academic classes. For eligibility at the Division II level, student athletes must hold a minimum of a 2.2 GPA in their core academic classes***
Visual and Performing Arts	1	1	
Health and Fitness	2 <i>(1.5 Fitness, 0.5 Health)</i>		
Career and Technical Education	1		
Electives	5		
TOTALS	24		

HIGH SCHOOL GRADUATION REQUIREMENTS

Choice #1: English Class

ENGLISH COURSES			
9 th Grade:	10 th Grade:	11 th Grade:	12 th Grade:
English 9 (1201) English 9 Honors (1251)	English 10 (1203) English 10 Honors (1253)	English 11 (1205) AP English Language (1255)	BTC English (1209) AP English Literature (1257)
		Mythology (1274) Creative Writing (1272)	CiHS African American Lit (1225) CiHS Native American Lit (1229)



Choice #2: Math Class

MATH COURSE PROGRESSIONS				
	9 th Grade	10 th Grade	11 th Grade	12 th Grade
Progression #1	Geometry (3306)	Algebra 1 (3303)	Algebra 2 (3352)	Algebra 2 (3352) Pre-Calculus (3831) CiHS Math 107(3843) AP Statistics (3860) BTC Math (3345)
Progression #2	Geometry (3306)	Algebra 1 (3303)	Intermediate Math (3331)	BTC Math (3345) Algebra 2 (3352)
Progression #3 <i>*student took Alg 1 in middle school</i>	Geometry (3306)	Algebra 2 (3352)	Pre-Calculus (3831) CiHS Math 107 (3843) AP Statistics (3860)	AP Calculus AB (3505) AP Calculus BC (3507) CiHS Math 107 (3843) AP Statistics (3860)
Progression #4 <i>**student took Alg 1 and Geo in middle school</i>	Algebra 2 (3352)	Pre-Calculus (3831)	AP Calculus AB (3505) AP Calculus BC (3507)	CiHS Math 107 (3843) AP Statistics (3860)

Choice #3: Science Class

SCIENCE COURSE PROGRESSIONS

	9 th Grade	10 th Grade	11 th Grade	12 th Grade
Progression #1	Biology (5445) Biology MESA (5321)	Chemistry (5311) Chemistry MESA (5323) AP Biology (5207)	Chemistry (5311) Physics (5511) Anatomy & Physiology (5203)	AP Biology (5207) AP Chemistry (5313) AP Physics (5517)
Progression #2	PLTW Bio-Med Year 1 (5307)	PLTW Bio-Med Year 2 (5390)	PLTW Bio-Med Year 3 (5347)	PLTW Bio-Med Year 4 (5349)

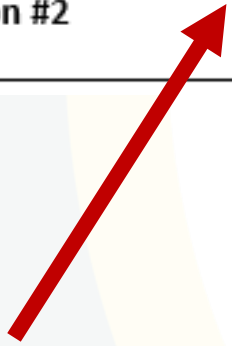

*****NOTE:** If choosing the PLTW Bio-Med Pathway, students whose post-secondary plans include attending a 4-year college/university will need to take an algebra-based science class (i.e., Chemistry, Physics) in conjunction to the PLTW Bio-Med classes.

Choice #4: Fitness & Health Class

FITNESS & HEALTH COURSES

Intro to Fitness (5911)

Health (5920)

→ Lifetime Fitness (5912)

→ Advanced Conditioning (5935)

→ *Advanced Conditioning (Zero-Hour) (5934)*



Choices #5 and #6: Electives



**Career &
Technical
Education (CTE)**

Arts & Music

World Language

Other Electives

Choices #5 and #6: Electives

Career & Technical Education (CTE)

- Business & Marketing/DECA
- Woods
- Metals
- Automotive
- Aerospace
- Manufacturing
- Digital Photography
- Web Design
- Stagecraft
- Child Development
- Foods & Nutrition
- Sports Medicine
- Plant Science
- Computer Science Essentials
- Military Studies/JROTC

Choices #5 and #6: Electives

Arts & Music

- Draw/Sculp/Paint
- Web Design
- Ceramics
- Digital Photography
- Intermediate Choir
- Band/Wind Ensemble
- Piano Lab
- Guitar Lab
- Percussion Ensemble
- Intermediate Orchestra
- Drama/Theatre

Choices #5 and #6: Electives

**World
Language**

- Spanish
- French
- Chinese

Choices #5 and #6: Electives

Other Electives

- AVID 9
- Debate
- AP Human Geography



SPHS to be 9th Grade Registration and Advising Form: 2024-2025

Student ID # _____

Current Middle School: _____

LAST Name: _____

FIRST Name: _____

HIGH SCHOOL & BEYOND PLAN	SPECIAL PROGRAMS
<p>Career Interest: _____</p> <p>Education Needed:</p> <p><input type="checkbox"/> 4-Year College <input type="checkbox"/> 2-Year College <input type="checkbox"/> Technical School</p> <p><input type="checkbox"/> Apprenticeship <input type="checkbox"/> Military <input type="checkbox"/> Other/Workforce</p>	<p><input type="radio"/> ELD</p> <p><input type="radio"/> IEP Case Manager: _____</p> <p>Goal Areas: _____</p> <p>_____</p>

CORE CLASSES		CHOICES
1	<p>ENGLISH: Choose 1</p> <p><input type="checkbox"/> English 9 (1201) <input type="checkbox"/> English 9 Honors (1253)</p>	<p>For more information about the Shadle Park High School registration process, course descriptions, and upcoming events, please visit our 2024-2025 course registration webpage!</p> 
2	<p>SCIENCE: Choose 1</p> <p><input type="checkbox"/> Biology (5445)</p> <p><input type="checkbox"/> Biology MESA (5321)</p> <p><input type="checkbox"/> PLTW Principles Biomedical Science (5307)</p>	
3	<p>MATH: Choose 1</p> <p><input type="checkbox"/> Geometry (3306) <input type="checkbox"/> Algebra 2 (3352)</p>	

Completed Registration Form

Registration Forms: 2024 - 2025

New Student

New Student Registration

This form is **required** for all new students and will be available beginning Jan. 1, 2024.

School Choice

School Choice Application

Starting Jan. 1, 2024, complete this form if you are interested in an option school or "choicing" to a school outside your neighborhood school.

If you are new to SPS, you must first complete the New Student Registration Form.

Enrollment Verification



Enrollment Verification

This form is for students already enrolled in Spokane Public Schools to confirm they will continue at SPS and will be available later in the spring.



up
next

- **Feb 7- Odyssey registration**
- **Feb 8- Salk registration**
- **Feb 9- Montessori registration**
- **Feb 13- Glover registration**
- **Feb 14- Flett registration**
- **Feb 21- Garry registration**



- **May 2024 (6:00pm)** – Future Highlander Night (meet coaches/advisors, review registration choices)
- **May/June 2024** – 8th Grade Visits to SPHS
- **August 2024**– Student Schedules Available, 9th Grade Orientation (School Expectations, School Tours, Transportation), Fall Sports Begin
- **September 2024** – Launch Conferences, High School Career Begins



THE PODIUM





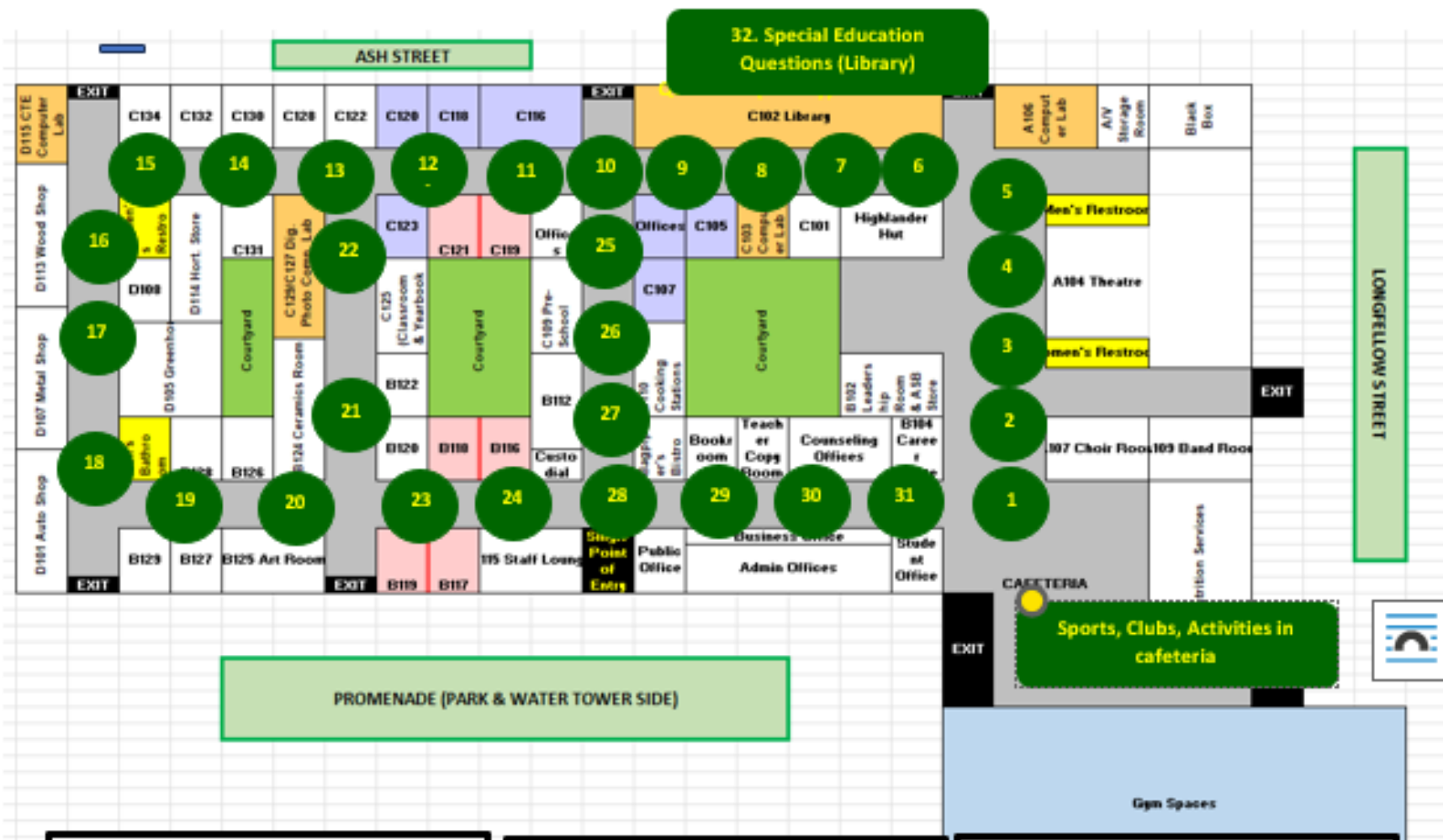

- 9th Grade Course Offerings (Pt. 1)**
13. Math: Geometry/Alg 2
 14. Science: PLTW
 15. Science: Biology
 16. Woods/Metals/Aerospace Manufacturing
 17. Plant Science
 18. Auto Mechanics
 19. Sports Med
 20. Drawing, Sculpting, Painting
 21. Ceramics
 22. Digital Photo

- 9th Grade Course Offerings (Pt. 2):**
1. Health/Fitness (PE)
 2. Band/Orchestra
 3. Piano Lab/Guitar Lab/ Choir
 4. Military Studies/JROTC
 5. Theatre/Drama
 6. AVID 9
 7. Business & Marketing/DECA
 8. PLTW Computer Science Essentials/Web Design
 - 9.
 - 10.
 - 11.

- 9th Grade Course Offerings (Pt. 3):**
23. English: English 9/English 9 ~~ORA~~
 24. Social Studies: AP Human Geography
 25. Special Education
 26. Child Development
 27. Foods & Nutrition
 28. ELD
 29. Spanish/World Lang
 30. French
 31. Debate
 32. Special Education (In Library)

PROUD TO BE

